

Smart Building Control Systems by GVS :

KNX/EIB System
Video Intercom System



Catalogue



KNX Smart Touch V50s
A multi-functional KNX touch panel designed for elegance
→P. 008

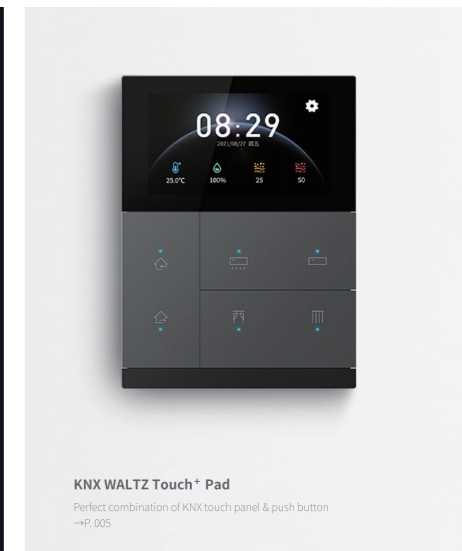

KNX WALTZ Touch+ Pad
Perfect combination of KNX touch panel & push button
→P. 005

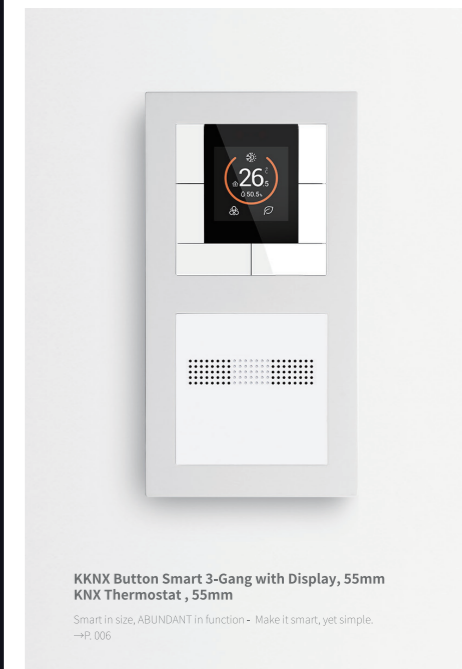

KKNX Button Smart 3-Gang with Display, 55mm KNX Thermostat , 55mm
Smart in size, ABUNDANT in function - Make it smart, yet simple.
→P. 006



Guangzhou Video-Star Intelligent Corp.,Ltd

Tel: +86 20 82088388
www.gvssmart.com
info@gvssmart.com

F3 / Building#5, No. 9, 4th Lanyu St.,
Huangpu District,Guangzhou, 510730,
P. R. China

GVS Since 1999

Since 1999, GVS has been focusing on building control technologies, offering it's worldwide clients with quality products and professional services.

As a hi-tech company, GVS is now a pioneer in smart building industry, the company operates mainly in business line of smart building, video intercom and smart Wi-Fi thermostat. Started as a CRT manufacturer for security devices, the company has now grown and expanded into a smart building product & service provider with its professional team in design, R&D, manufacturing and sales. With its highlighted capability in display and building technology, the company has long been in the first rankings of suppliers for both KNX building control system, IP/2-wire video intercom system and smart Wi-Fi product. As the FIRST native BOARD MEMBER of KNX CHINA and first-ranking video intercom & thermostat supplier, GVS will continue to renovate and contribute to the smart building technologies in the coming decades.

Just like the slogan goes: To make life smart, and smart simple!



Professional Manufactory

Facility & Equipment: modern factory with SMT, plug-in, assembling, testing lines; QC, electrical safety labs, high-low temperature aging room;

Standard & Certificate: ISO90001, QC080000, RoHS, CE, KNX, FCC.

Production Capacity (annually): TFT & display module 4.5M pcs, KNX device 300K pcs, video intercom device 400K pcs.

Video Intercom Pathfinder

Dated back to 1999, GVS started with audio intercom module business, later developed to video intercom module. Started from analog 2-wire system, GVS now offers its client with full digital IP intercom solution, with perfect integration with smart home functions. GVS has never stopped on the way of exploration and innovation for a smarter and more secured life style.



GVS - Milestones

In 1999	In 2008	In 2011	In 2013	In 2015	In 2017	In 2018	In 2019	In 2021	In 2022
GVS was established.	GVS became the first Chinese KNX member in China.	First KNX Training Center in China was established by GVS.	Initiator and Chairman of the drafting team for IEEE1888.4 Green Home & Building Automation.	GVS became the FIRST native council member of KNX China.	GVS became a public company by entering NEEQ (the New OTC).	GVS became the first native company who chaired KNX CHINA.	GVS entered the smart thermostat market by acquiring Vine Connelcted Corp.	GVS survived & thrived with 30% annual net growth in 2020 & 2021 despite COVID-19.	FIVE-YEAR-PLAN for BSE launched with brand new GVS VI and vision.

Product Series

KNX Home & Building Control System
P. 004 - P. 013

KNX Home & Building Control System

KNX Smart Home Solution

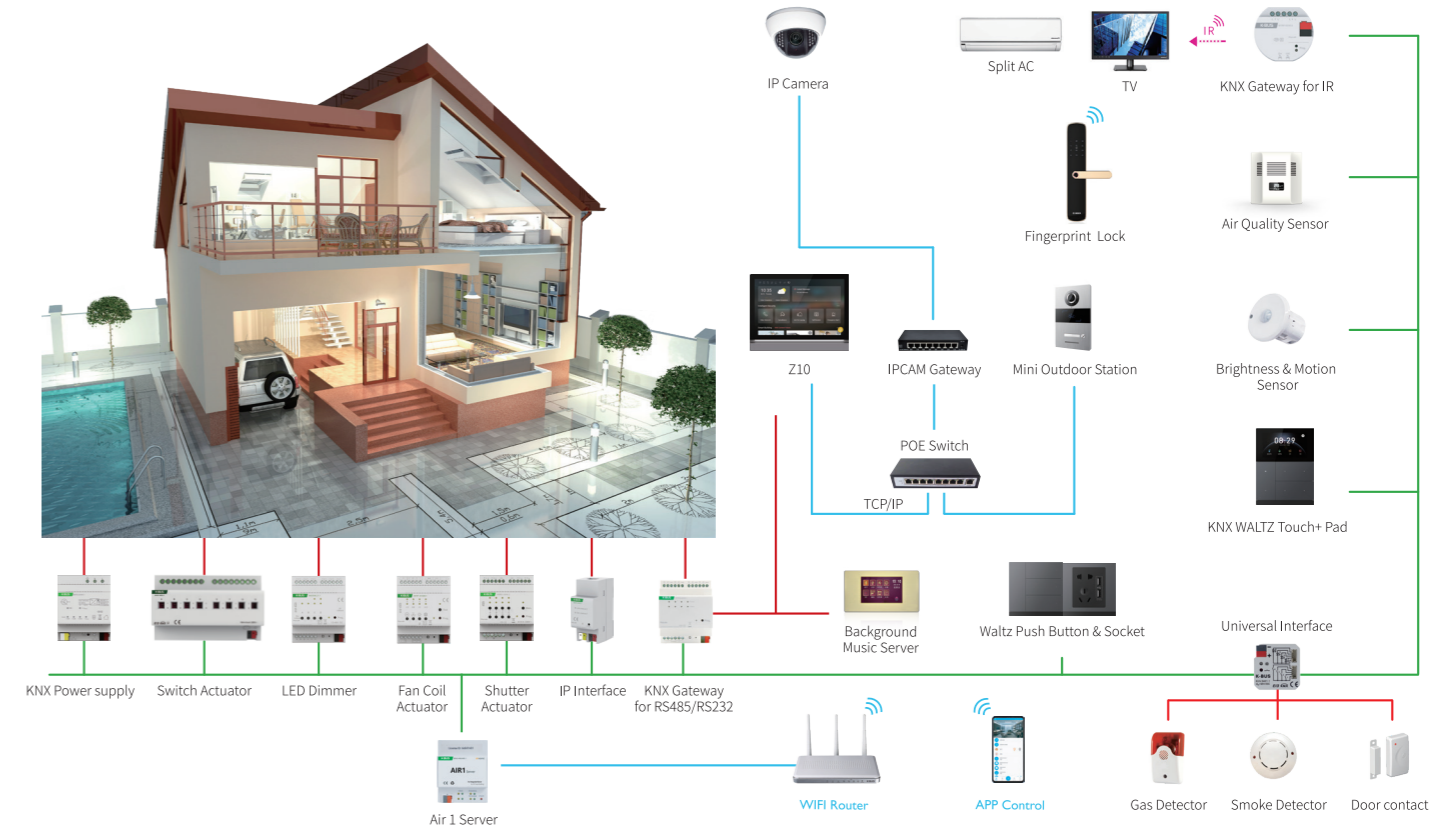

KNX Smart Hotel Solution

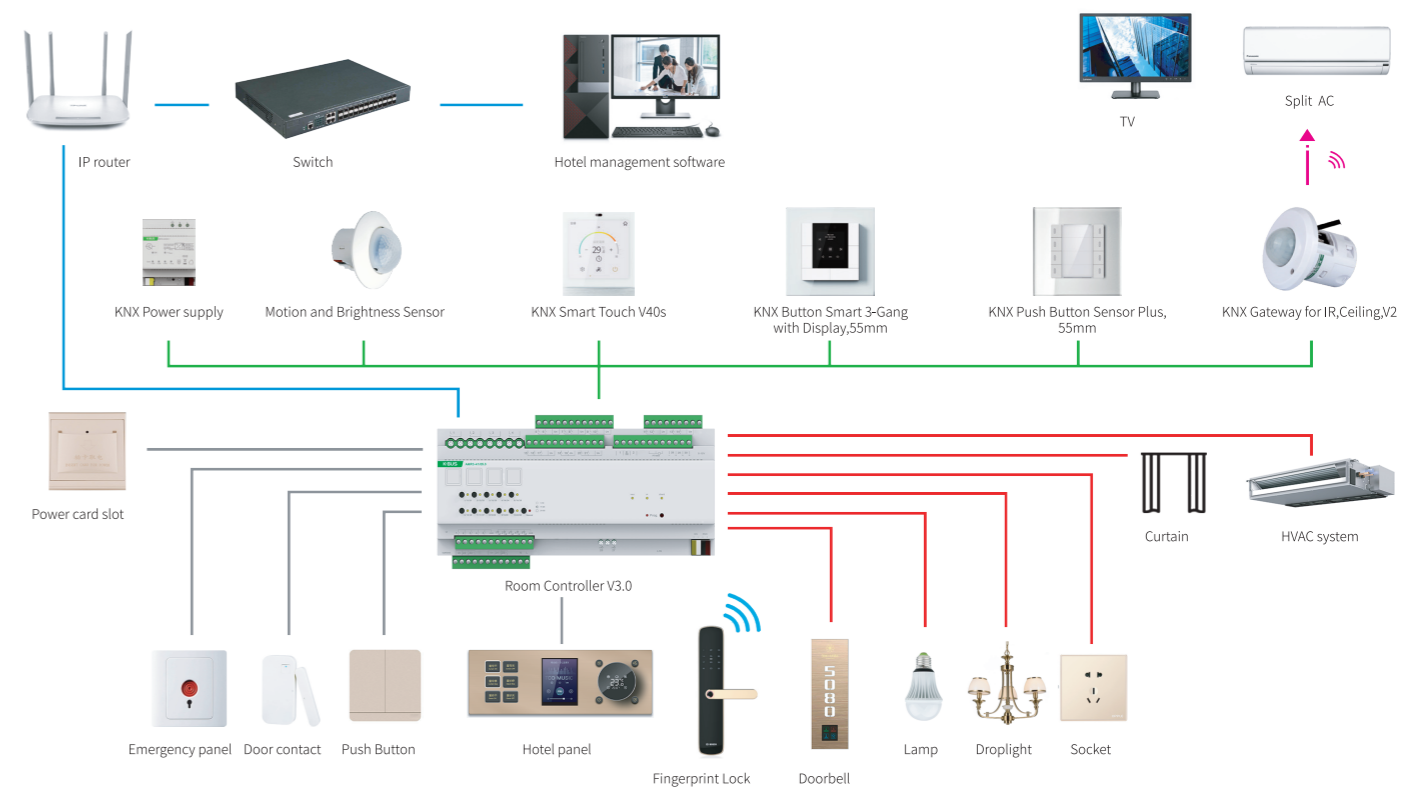

KNX WALTZ Touch + Pad **NEW!**

Plastic: CHTFB-3.0/6.1.00(White)
 CHTFB-3.0/6.1.01(Black)
 CHTFB-3.0/6.1.02(Silver)
 CHTFB-3.0/6.1.03(Gray)
 CHTFB-3.0/6.1.04(Gold)

Metal: CHTFB-3.0/6.1.20(White)
 CHTFB-3.0/6.1.21(Black)
 CHTFB-3.0/6.1.22(Silver)
 CHTFB-3.0/6.1.23(Gray)
 CHTFB-3.0/6.1.24(Gold)

Function:

- Elegant design mixed with IPS capacitive touch panel & mechanical button
- Aluminum frame and replaceable buttons (plastic/aluminum)
- Synchronized animation effects on display when buttons pressed
- Push Buttons adjustable for 1 or 2 button operation
- Built-in temperature sensor, RGB status LED indication
- Adjustable for button push length, NO or NC contact operation
- Short/long operation for KNX functions of lighting, scene control, shutter etc.
- Supporting ring included for installation, integrated bus coupling unit
- 3 years' warranty, 5 classic colors available

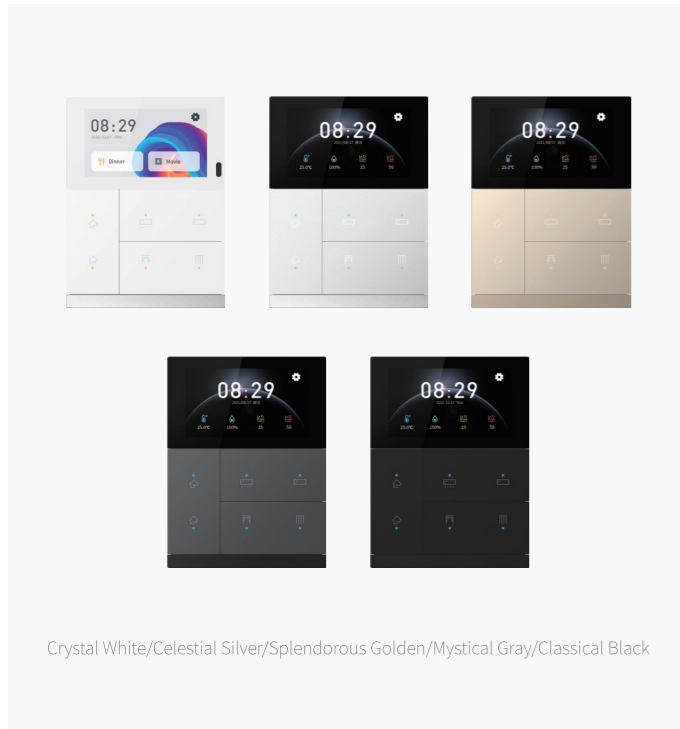

Crystal White/Celestial Silver/Splendorous Golden/Mystical Gray/Classical Black

KNX WALTZ Push Button Pro **NEW!**

Metal: CHPB-04/02.1.2x (2-Gang)
 CHPB-06/02.1.2x(3-Gang)
 CHPB-08/02.1.2x(4-Gang)
 x=0, While; x=1, Black; x=2 Silver; x=3 Gray; x=4 Gold

Function:

- Latest elegant KNX push buttons for WALTZ Series
- Push Buttons adjustable for 1 or 2 button operation
- Aluminum frame and replacable aluminum button
- Built-in voice control and temperature sensor, with LED indication
- Adjustable for button push length, NO or NC contact operation
- Short/long operation for KNX functions of lighting, scene control, shutter etc.
- Supporting ring included for installation, integrated bus coupling unit
- 3 years' warranty, 5 classic colors available

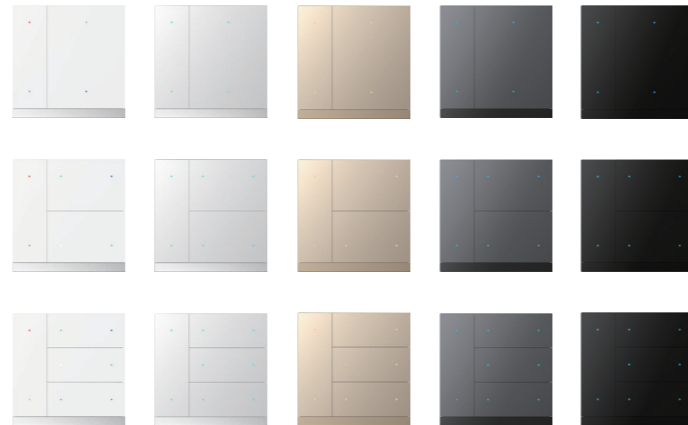

Waltz Electrical Socket & Accessories (For 86x86mm wall-box ONLY) **NEW!**



Socket
CHSU-04/10.1.01



Network Socket
CHTN-02/00.1.01



Emergency Button
CHEK-01/00.1.01



KNX Button Smart 3-Gang with Display, 55mm

CHPBL-03/00.1.00 CHPBL-03/00.2.00 CHPBL-03/00.2.01

Function:

- 100% fits 55mm systems:
 - GIRA Standard 55,E2,E22,Esprit
 - MERTEN 1M,, M-Pure,M-Smart
 - Jung Aplus,Acreation,A500, AS50
 - BERKER B3,B7,S1
- Support KNX Secure
- LCD Display,resolution 240*240
- Built-in temperature & humidity sensor,2-fold input interfaces
- Option 1: Push Button (3 pages,4 object/p) for all KNX functions
- Option 2: Thermostatic pages, AC(FCU,VRF), floor heating and ventilation
- Option 3: Background music pages: author/album/song display

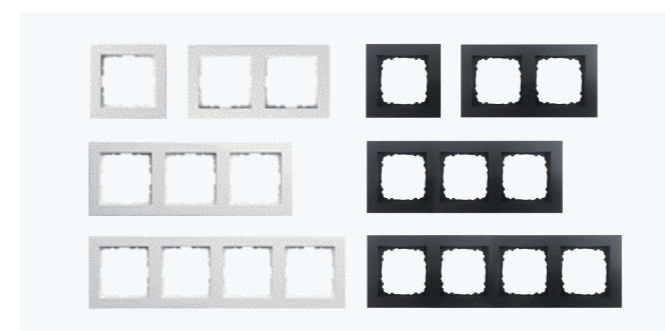
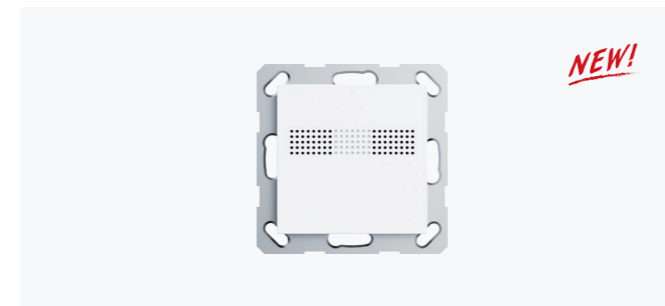

Plastic frame 1/2/3/4-fold, black/white for 55mm system

KNX Push Button Sensor Plus, 55mm

CHPLE-0x/02.y.0z
 (x=1,2,3,4 means 1,2,3,4-Gang;y=1,2 means Shiny/Matt finish;
 z=1,3 means White/Black)

Function:

- 100% fits 55mm systems:
 - GIRA Standard 55, E2, E22, Esprit
 - MERTEN 1M,, M-Pure, M-Smart
 - JUNG Aplus, Acreation, A500, AS500
 - BERKER B3, B7, S1
- Push Buttons adjustable for 1 or 2 button operation
- Built-in temperature sensor, RGB status LED indication
- Adjustable for button push length, NO or NC contact operation
- Short/long operation for KNX functions of lighting, scene control, shutter etc.
- Centered title block with cover film for customized marking
- Supporting ring included for installation, integrated bus coupling unit
- 3 years' warranty, matt/shiny finish available, white/black available



KNX Thermostat Lite, 55mm

CHTL-02/00.2.00

Function:

- Built-in temperature and humidity sensor
- Control modes: heating/cooling, with 2/4-pipe system
- HVAC operation modes: comfort, standby, economy, protection
- Temperature logic algorithm supports 2-point and PI control
- Support 2 external inputs of dry contact or NTC temperature detection
- Support the KNX Secure protocol

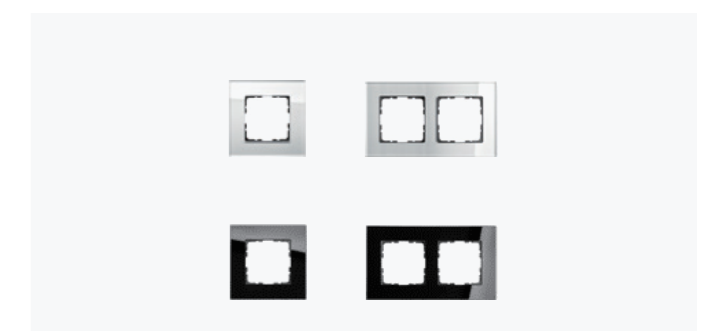

Glass frame 1/2-fold, black/white for 55mm system

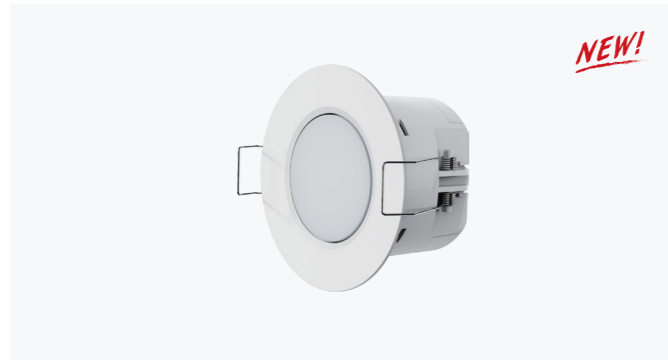

KNX Presence Sensor, microwave type

CSBPM-04/00.1.00

Function:

- Detections of normal movement, tiny movement and static presence, with 24GHz millimetres wave technology
- Sensitivity is configurable and can be adjusted by day/night
- Internal temperature and humidity sensors
- Constant lighting control
- RTC controller functions
- Logic functions and scene group functions
- Support the KNX Secure protocol

KNX PIR Motion Sensor

CSBP-04/00.1.00

Function:

- Detection of movement, with ordinary pyroelectric infrared technology
- Internal brightness sensor, and control the light via brightness threshold and also control logically with motion signal
- Internal temperature and humidity sensors
- Constant lighting control
- RTC controller functions
- Logic functions and scene group functions
- Support the KNX Secure protocol
- Support both ceiling and wall-box mounting



KNX Heating Actuator with Triac, 6 Fold

AFHT-06/05.1

Function:

- Support KNX Secure
- Support 24V AC or 230V AC valve
- Bus voltage failure alert, manual operation with LEDs
- Winter/Summer Mode
- Supports 24V AC or 230V AC themal drive. 6
- independent valve outputs, max. 300mA/ch
- 6 channels of room temperature controller: support heating/cooling mode, integrating
- 2-point/PI control with 5 scene function

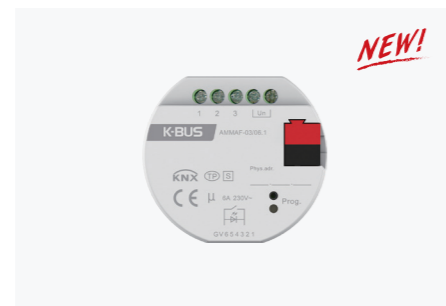

KNX Multifunctional Actuator 3-Fold,6A

AMMAF-03/06.1

Function:

- 6A/channel, un rated voltage 250V AC, 50-60Hz, total current of 3 channels less than 12A
- Main KNX functions including switching, status response, scene control (8 folds), time switching, preset, logic operation, shutter, valve, heating, fan control
- 6-fold dry contact in/output, LED indicator
- Fits in 86*86mm and German 60mm wall boxes

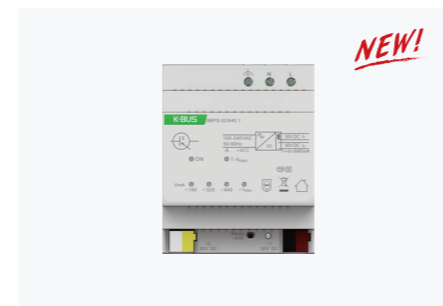

KNX Power Supply, 640mA

BBPS-02/640.1

Function:

- Input voltage: 100V ~240 Vac, 47-63Hz
- Sustained short-circuit current: < 1.4 A
- Rated current: 640mA, short-circuit-proof
- 1-fold KNX output
- 1-fold Auxiliary voltage output
- Output staus display
- Reset the KNX output
- Over temperature protection
- Current consumption level indication



KNX Smart Touch Z10

A-IS03 A-IS04

Function:

- Smart touch panel for both KNX and video intercom
- Aesthetic design with aluminum faceplate
- 10.1 inch colored IPS touch screen, 1280x800 resolution
- Support both map-view and list-view of all KNX functions
- Colored breathing light adjustable for color temp and brightness
- 8 time functions, 4 event group functions and 8 logic functions
- Switching, dimming, curtain control, HVAC and other KNX functions
- Support German standard twin-60mm wallbox installation
- Starry grey and aurora red available



KNX Smart Touch V50/V50s

BV: CHTF-5.0/15.3.21 BH: CHTF-5.0/15.4.21 B50s: CHTF-5.0/15.5.21

SV: CHTF-5.0/15.3.22 SH: CHTF-5.0/15.4.22 S50s: CHTF-5.0/15.5.22

Function:

- Standard KNX Touch Panel with database & certificate
- 5" colored capacitive IPS touch screen, resolution 480*854
- Up to 2 home pages and 15 function pages can be configured
- 16 time functions, 8 event group functions, 8 logic functions
- Password protection and customized screensaver
- Support switching, dimming, shutter control, HVAC control etc.
- Built-in temperature sensor
- Available with two colors silver & black , two types vertical & horizontal
- Supporting ring included for installation, perfectly fits 60mm/86mm wallbox

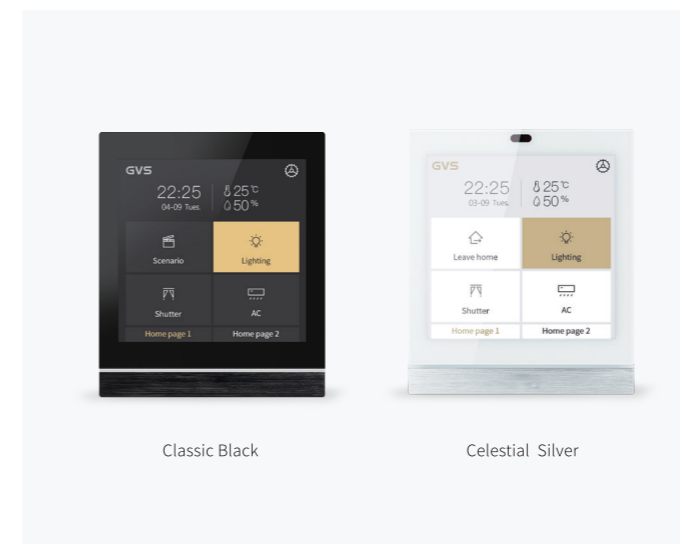

KNX Smart Touch V40/V40s/V40Lite

CHTF-4.0/15.3.21 CHTF-4.0/15.4.21 CHTF-4.0/15.5.21

CHTF-4.0/15.3.22 CHTF-4.0/15.4.22 CHTF-4.0/15.5.22

Function:

- Standard KNX Touch Panel with database & certificate
- 4" colored capacitive IPS touch screen, resolution 480*480
- V40 15pages, V40s 9pages, V40 lite 6pages
- 16 time functions, 8 event group functions, 8 logic functions(except V40 Lite)
- Password protection and customized screensaver
- Support switching, dimming, shutter control, HVAC control etc.
- Built-in temperature sensor
- Available with two colors silver & black
- Supporting ring included for installation which fits 60mm/86mm wallbox

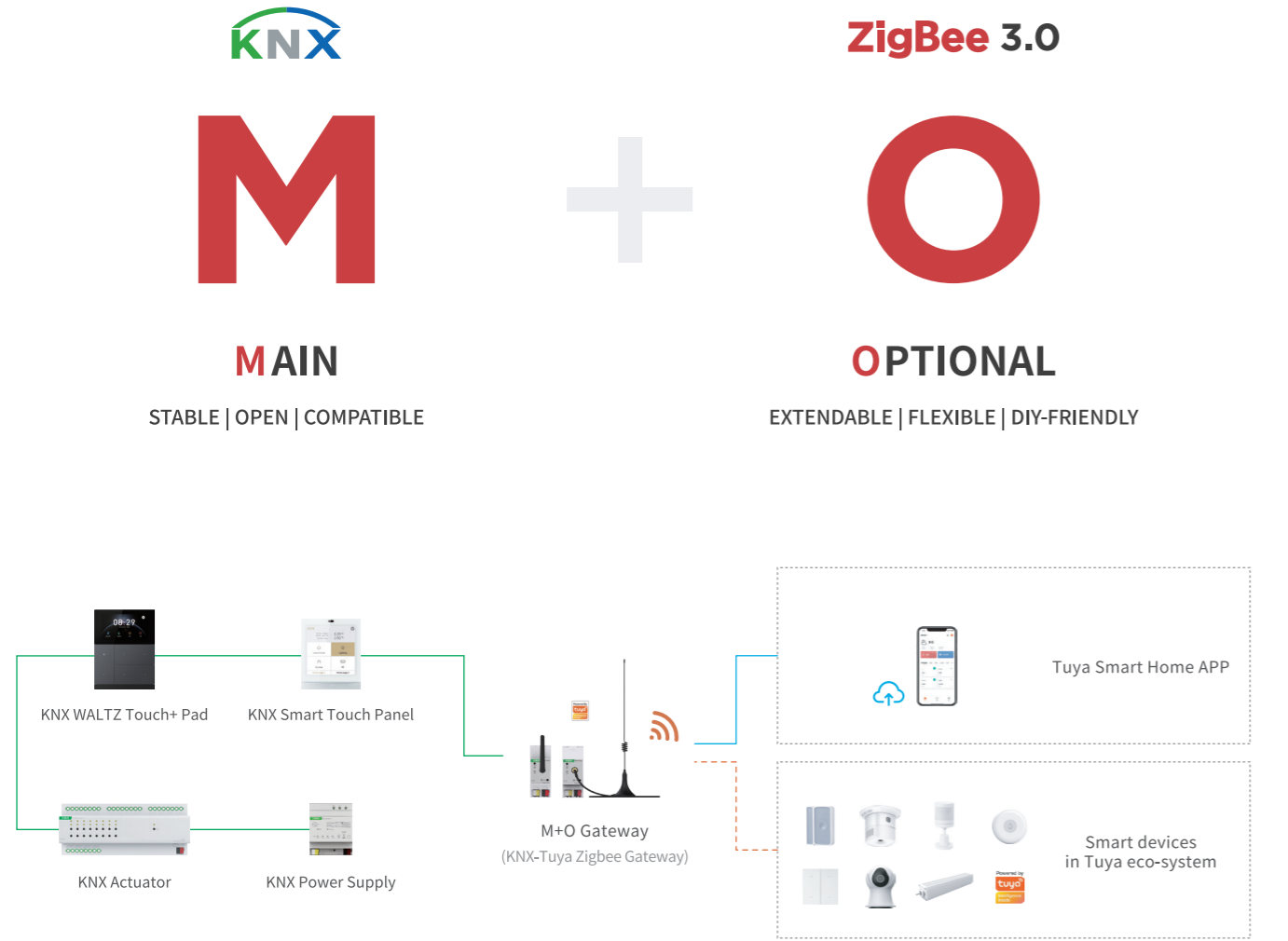

KNX/Tuya-Zigbee3.0 Gateway

V1.0 BTMO-TY/00.1 BTMO-TY/00.2 (Zigbee → KNX)
 V2.0 BTMO-TY/00.3 BTMO-TY/00.4 (Zigbee ↔ KNX)

Function:

KNX/Tuya-Zigbee3.0 Gateway is an innovative device which coupling KNX and Tuya Zigbee system. By easy programming, you can realize controlling KNX devices from Tuya APP, and uploading status information of KNX devices to Tuya platform, hence monitor and manage the devices conveniently. There're 2 versions, V1.0 supports only control from Tuya APP to KNX devices; V2.0 supports bidirectional communication & control between KNX and Tuya/Zigbee.

- Work as a Tuya/Zigbee Gateway to connect to Tuya Cloud and add Tuya device.
- Upload KNX devices to Tuya platform to control and display status.
- Support KNX functions: switching, dimming, curtain, scene, AC control, background music, air quality and energy metering display etc.
- Logic functions.
- Support bidirectional communication between Zigbee and KNX device(V2.0).



Picture	Name / Model	Installation / Dimension	Function
	KNX Smart Touch Z10 A-IS03	Product size: 240×186.8×8mm Coupler size: fits 86×86×60mm	Smart touch panel for both KNX and video intercom Aesthetic design with aluminum faceplate 10.1 inch colored IPS touch screen, 1280×800 resolution Support both map-view and list-view of all KNX functions 8 time functions, 4 event group functions and 8 logic functions Switching, dimming, curtain control, HVAC and other KNX functions
	KNX Smart Touch V50/V50s BV: CHTF-5.0/15.3.21 SV: CHTF-5.0/15.3.22 BH: CHTF-5.0/15.4.21 SH: CHTF-5.0/15.4.22 B50s: CHTF-5.0/15.5.21 S50s: CHTF-5.0/15.5.22	86×148.8×32.5mm 148.8×86×32.5mm	Standard KNX device with database & certificate 5" color capacitive IPS touch screen, resolution 480*854 16 time functions, 8 event group functions, 8 logic functions Password protection and customized screensaver Support switching, dimming, shutter control, HVAC control and other main KNX functions, built-in temperature sensor Supporting ring included for installation, fits 60mm/86mm wallbox
	KNX Smart Touch V40/V40s/V40Lite CHTF-4.0/15.3.21 CHTF-4.0/15.3.22 CHTF-4.0/15.4.21 CHTF-4.0/15.4.22 CHTF-4.0/15.5.21 CHTF-4.0/15.5.22	86×101.3×32.2mm	Standard KNX Touch Panel with database & certificate 4" color capacitive IPS touch screen, resolution 480*480 V40 15pages, V40s 9pages, V40 lite 6pages 16 time functions, 8 event group functions, 8 logic functions(except V40 Lite) Password protection and customized screensaver Support switching, dimming, shutter control, HVAC control etc. Supporting ring included for installation, perfectly fits 60mm/86mm wallbox
	KNX WALTZ Touch+ Pad Plastic Button: CHTFB-3.0/6.1.00(White) CHTFB-3.0/6.1.01(Black) CHTFB-3.0/6.1.02(Silver) CHTFB-3.0/6.1.03(Gray) CHTFB-3.0/6.1.04(Gold) Metal Button: CHTFB-3.0/6.1.20(White) CHTFB-3.0/6.1.21(Black) CHTFB-3.0/6.1.22(Silver) CHTFB-3.0/6.1.23(Gray) CHTFB-3.0/6.1.24(Gold)	115×86×34.7mm	IPS capacitive touch panel & mechanical button Aluminum frame and replaceable buttons (plastic/aluminum) Push Buttons adjustable for 1 or 2 button operation Built-in temperature sensor, RGB status LED indication Adjustable for button push length, NO or NC contact operation Short/long operation for KNX functions of lighting, scene control, shutter etc. 3 years' warranty, 5 classic colors available
	KNX WALTZ Push Button Pro CHPB-04/02.1.2x (2-Gang) CHPB-06/02.1.2x(3-Gang) CHPB-08/02.1.2x(4-Gang) x=0, White; x=1, Black; x=2 Silver; x=3 Gray; x=4 Gold	86×86×34mm	Latest elegant KNX push buttons for WALTZ Series Push Buttons adjustable for 1 or 2 button operation Aluminum frame and replaceable aluminum button Built-in voice control and temperature sensor, with LED indication Adjustable for button push length, NO or NC contact operation Short/long operation for KNX functions of lighting, scene control, shutter etc. Supporting ring included for installation, integrated bus coupling unit 3 years' warranty, 5 classic colors available
	Push Button Sensor Plus, 1/2/3/4-gang CHPLE-02/02.x.0y CHPLE-04/02.x.0y CHPLE-06/02.x.0y CHPLE-08/02.x.0y (x=1,2; y=0,1)	55.4×55.4×18.7mm	Switching and dimming Shutter control Value sending RGB and RGBW dimming Built-in Temperature sensor Logic functions Event Group function Matt and shiny finish LED indication, label instruction White and black available
	KNX Button Smart 3-Gang with Display, 55mm White shiny: CHPBL-03/00.1.00 White matt: CHPBL-03/00.2.00 Black matt: CHPBL-03/00.2.01	55.3×55.3×19.3mm	Support KNX Secure LCD Display, resolution 240*240 Built-in temperature & humidity sensor, 2-fold input interfaces Option 1: Push Button (3 pages, 4 object/p) for all KNX functions Option 2: Thermostatic pages, AC(FCU, VRF), floor heating and ventilation Option 3: Background music pages: author/album/song display
	KNX Thermostat Lite, 55mm CHTL-02/00.2.00	55.3×55.3×19.3mm	Built-in temperature and humidity sensor Control modes: heating/cooling, with 2/4-pipe system HVAC operation modes: comfort, standby, economy, protection Temperature logic algorithm supports 2-point and PI control Support 2 external inputs of dry contact or NTC temperature detection Support the KNX Secure protocol
	KNX 2/4/6-Button Touch Switch CHTB-02/01.2.2x CHTB-04/01.2.2x CHTB-06/01.2.2x (x=0, 2, 4)	86×86×8.9mm	Switching and dimming Control of blinds and shutters Sending of values, e.g. water line, brightness Recall and storage scene Bi-LED indication Glass touch control











Product List

Picture	Name / Model	Installation / Dimension	Function
	KNX Switch Actuator, 4/8/12-Fold, 16A/20A (Normal) (Current Mnt) KA/R 0416.2 ARCD-04/16.2 KA/R 0420.1 KA/R 0816.2 ARCD-08/16.2 KA/R 0820.1 KA/R 1216.2 ARCD-12/16.2 KA/R 1220.1	DIN rail 90×72×64mm 90×144×64mm 90×216×64mm	Manual switch operation, switch status response Reaction after bus voltage failure and recovery Scene and preset control Logic operation with AND, OR, XOR, gate function Forced operation and safety function, threshold and time function NORMAL version and CURRENT MEASUREMENT version for option.
	KNX Multi-functional Actuator, 4/8/16/24-Fold Switch/Shutter/Fancoil AMMA-04/06.1 AMMA-08/10.1 AMMA-16/10.1 AMMA-24/10.1	DIN rail 36×90×64mm 72×90×64mm 216×90×64mm	Multifunctional actuator with flexibility, one actuator for all functions, Max. 24 folds of switching output for lighting, socket etc. Max. 12 folds of AC/dry contact shutter/blinds control; Max. 6 folds of DC shutter/blinds control Max. 6 folds 3-level fan speed control 2/4-pipe valve system of both 3-point type and ON/OFF type
	KNX SCR Dimming Actuator, 2/4-Fold, 300w/ch KA/D 0215.S.1 KA/D 0415.S.1	DIN rail 144×90×64mm 216×90×64mm	Switching Relative dimming Absolute dimming Status report, error report Up to 15 scenes setting Preset and set preset function Staircase lighting function Support set Brightness value after bus voltage recovery Leading edge phase cut dimming Adjust dimming curve via manual buttons Manual operation and status indication
	KNX 1-10V Dimming Actuator ADTV 04/16.1	DIN rail 90×144×64mm	Switching Relative and absolute dimming Status report, error report Scene and preset function Staircase lighting function Preset a Brightness value after bus voltage recovery Passive DC 0/1-10V drive mode Manual operation and status indication
	KNX LED Dimming Actuator, 4-Fold, 4A ADLD-04/03.1	DIN rail 90×72×64mm	Switching Relative and absolute dimming Status report, error report Scene and preset function Staircase lighting function Preset a Brightness value after bus voltage recovery Constant voltage drive mode Manual operation and status indication
	KNX Fan Coil Controller, 0-10V AFVFT-07/10.1	DIN rail 90×72×64mm	Support 2/4 pipes HVAC system Support 2 wire or 0-10V valve type Support 2-point control or PI control methods for local Support relay/0-10V drive fan, 3-level fan speed Standby/comfort/night/protect mode Channels can be reused as switch output Manual operation and LED indication Support 3-wire PT1000 sensor
	KNX Heating Actuator with Triac, 6 Fold AFHT-06/05.1	DIN-rail Mounted 72×90×64mm	Support KNX Secure Supports 24V AC or 230V AC thermal drive. 6 independent valve outputs, Max. 300mA/channel. 6 channels of room temperature controller: support heating/cooling mode, integrating 2-point and PI control algorithm, with 5 scenes functions.
	KNX Shutter Actuator V2, 4-Fold AWBS-04/06.2	DIN rail 90×72×64.1mm	Movement UP/DOWN Stop/Louver adjustment Move to position 0...100% Scenes Automatic sun protection Block Forced operation LED display Move into preset position (up to 2 preset positions) Set preset position (modification of the preset position during operation) Adjustment louver to position 0...100% (only Blind working mode) Monitoring of wind, rain and frost protect (cyclical) Status reply of the current position, status reply of the current operating mode Two operation mode: Venetian Blind and Shutter
	KNX Room Controller V3.0 AMRP-41/05.3	DIN rail 216×90×64mm	Dry contact and binary inputs LED indications Switch/shutter outputs Triac dimming Fan coil output 0-10V dimming Logic, Time and Scene group functions Support KNXnet/IP tunneling/ routing
	KNX Multifunctional Actuator 3-Fold, 6A AMMAF-03/06.1	Flush Mounted 53×48.3×23.5mm	Switch output Curtain output Valve control Dry input detection Fan control Heating control Drive LED indicator

Product List

Picture	Name / Model	Installation / Dimension	Function
	KNX Air Quality Sensor V2 CSAQI-06/00.1.00 CSAQI-06/00.1.01	86×86×48.3mm	PM2.5, PM10, VOC,AQI,CO2 detection and display Temp,humidity detection and display Warning for value detection Heating or cooling control output Built-in ventilation controller Logic control functions VOC, CO2, alarm output AQI, Humidity level alarm output
	KNX Presence Sensor, microwave type CSBPM-04/00.1.00	Ceiling-Mounted φ65×38mm	Detections of normal movement, tiny movement and static presence, with 24GHz millimetres wave technology Sensitivity is configurable and can be adjusted by day/night Internal temperature and humidity sensors Constant lighting control RTC controller functions Logic functions and scene group functions Support the KNX Secure protocol
	KNX PIR Motion Sensor CSBP-04/00.1.00	Ceiling-Mounted Wall-mounted φ70×51.5mm (Round) 86×86×51.5mm (Square)	Detection of movement, with ordinary pyroelectric infrared technology Internal brightness sensor, and control the light via brightness threshold and also control logically with motion signal Internal temperature and humidity sensors Constant lighting control RTC controller functions Logic functions and scene group functions Support the KNX Secure protocol Support both ceiling and wall-box mounting
	KNX IR Transmitter V2 (ceiling type) BTIRC-01/00.2	Ceiling-Mounted 91×82×76mm	360 degree full direction transmitting Support multi-emitting and delayed-emitting Installation height is max.4m, the transmitting distance is max.3m (radius) Support Universal IR control, up to 30 IR code Support Air-condition control, up to 266 IR codes
	KNX IR Transmitter 2-Fold V2 (flush-mounted) BTIRF-02/00.2	80/60mm wall box φ53×23.5mm	2 channels, flush mounted Support multi-emitting and delayed-emitting The transmitting distance is max.2m Support Universal IR control, up to 30 IR code Support Air-condition control, up to 266 IR codes Supports current detection, up to 10A
	IR Learner BTIL-01/00.2	18×20×77mm	Capability of learning over 95% remote control units in the market USB to communicate with PC, easy to learn and store IR codes from remote
	KNX Universal Interface, 4-Fold KI/U0401.1	46×46×11.7mm	Switching and dimming Control of blinds and shutters Sending of values, e.g. water line, brightness Recall and storage scene Switching sequence Counter Multiple operation LED indication output
	KNX Universal Interface, 4/8-Fold CTUI-04/04.1 CTUI-08/08.1	46×46×11.7mm	Switching and dimming Control of blinds and shutters Sending of values, e.g. water line, brightness Recall and storage scene 12V LED indication Switching sequence Counter Multiple operation LED indication output
	KNX Binary Input for floating contact, 4/8/16-Fold CTBIF-04/00.1 CTBIF-08/00.1 CTBIF-16/00.1	DIN rail 36×90×64mm 72×90×64mm	Switching and dimming Shutter function Value sending Recall and storage scene Shift register function RGB and RGBW dimming Multiple operation Delay mode logic functions Event Group function
	KNX Binary Input, 4-Fold CTBI-04/00.1	DIN rail 90×36×64mm	Switching and dimming Control of blinds and shutters Sending of values, e.g. water line, brightness Recall and storage scene Switching sequence Multiple operation LED indication Manual operation

Product List

Picture	Name / Model	Installation / Dimension	Function
	KNX/IP Interface BNIP-00/00.S	DIN rail 36×90×64mm	Support KNX Secure Support KNX/IP Tunneling Can be used as the programming interface for other KNX devices Support UDP telegram and port number 3671 Support up to 5 KNX IP client connections
	KNX Gateway for RS485/RS232 BTPG-04/03.1	DIN rail 72×90×64mm	Support the integration of Modbus and KNX system, with master and slave mode, and up to 500 datapoints Support data communication between RS232 and KNX system, and up to 100 datapoints Support data communication between RS485 and KNX system, and up to 100 datapoints Support the control of VRF/VRV air conditioners with Modbus RTU control protocol, such as DAIKIN, HITACHI, Mitsubishi, Fujitsu, Gree, Toshiba, etc. Support the control of DOOYA 485 curtain motor Support the control of some audio hosts unit in china manufacturers, such as backaudio, Yodaar, MiYue, cnWise, etc.
	KNX/DALI Gateway, 1/2-Fold BTDG-01/64.1 BTDG-02/64.1	DIN rail 90×72×64mm	Two-channel gateway with broadcast function 64 DALI devices per channel for single device, 32 DALI group control per channel Various status feedback, e.g. switch, brightness, operation hours etc. Fault detection of lamps and ballasts for DALI devices Monitoring DALI bus voltage, DALI bus current and DALI bus short circuit status
	Air1 Server Gateway BTAS-KNX/485.2	DIN rail 108×90×64mm	Standard KNX gateway for phone/tablet APP connection Support standard Tuya wireless protocol devices Support customized scenarios for end users Support cloud service with remote control of WIFI/3G/4G/5G
	AirHome Remote Pro (APP for remote control)	iOS download: iOS Appstore Android download: Googleplay Huawei Galaxy Xiaomi Market GVS website	Standard KNX gateway for phone/tablet/PC APP control Easy configuration with PC software Support customized scenarios for end users Support cloud service with remote control of WIFI/3G/4G/5G
	KNX/Tuya-Zigbee3.0 Gateway BTMO-TY/00.1 BTMO-TY/00.2 BTMO-TY/00.3 BTMO-TY/00.4	36×90×64mm	Work as a Tuya/Zigbee Gateway to connect to Tuya Cloud and add Tuya device Upload KNX devices to Tuya platform to control and display status Support KNX functions: switching, dimming, curtain, scene, AC control, background music, air quality and energy metering display etc. Logic functions Support bidirectional communication between Zigbee and KNX device(V2.0)
	KNX USB Interface BNUS-00/00.1	77×20×18mm	An interface between PC and KNX bus to configure, parameterize and commission KNX bus
	KNX IP Router BNIPR-00/00.1	DIN rail 36×90×71mm	Support 4 client connections Support KNXnet/IP, ARP, ICMP, IGMP, HTTP, UPnP, UDP/IP, TCP/IP, DHCP and Auto IP Can be used as line/backbone coupler to couple ethernet and KNX-TP lines Support filter table routing function Can be used as the programming interface
	KNX Line Coupler BNLC-00/00.1	DIN rail 36×90×71mm	As a KNX line coupler, it connects main line to backbone line, or line to main line As a KNX line repeater, it extends the length of bus line and the number of KNX devices
	KNX Power Supply, 640mA BBPS-02/640.1	DIN rail 72×90×64mm	Input voltage 95V-255V AC, 50/60Hz, output 1: 30V DC +1/-2V, SELV with choke; output 2: 30V DC +1/-2V, SELV without choke, total 640mA, short-circuit-protection. Current level indicator. The minimum distance between 2 power supply in a line is 300meter

Product Series

Video Intercom System
P. 015 - P. 027

TCP/IP Video Intercom

IP Video Intercom System Briefing

GVS H Series system is a full digital video intercom system based on TCP/IP technology, it supports to create topology for large building easily and allows project to be equipped with high intercommunication performance.

The system supports video intercom, information broadcast, multi-channel calling, alarm, home automation, lift calling etc. Taking advantage from the IP technology, the system is with much better video intercom performance and sophisticated integration to smart home system which enables much more powerful functions for a smart space.

The system provide wide range of devices to meet requirements of all kinds of projects, with a full range of door stations, indoor monitors and accessories, a flexible and powerful intercom system can be easily set up and function well in the shortest time.



TCP/IP Video Intercom

H Series Video Intercom System

The H Series system is a full digital video intercom solution based on TCP/IP protocol. It supports digital video intercom, information broadcast, multi-channel calling, room-to-room intercom, alarm, home automation etc. The solution provides clear and fluent video intercom service and security alarm, which enhances the community security.

The system could be defined and applied to different buildings with a wide-range functions, meanwhile, supporting both 24V PoE power and 48V standard PoE also makes the system more flexible for installations of all kinds.

H Series Video Intercom Topology

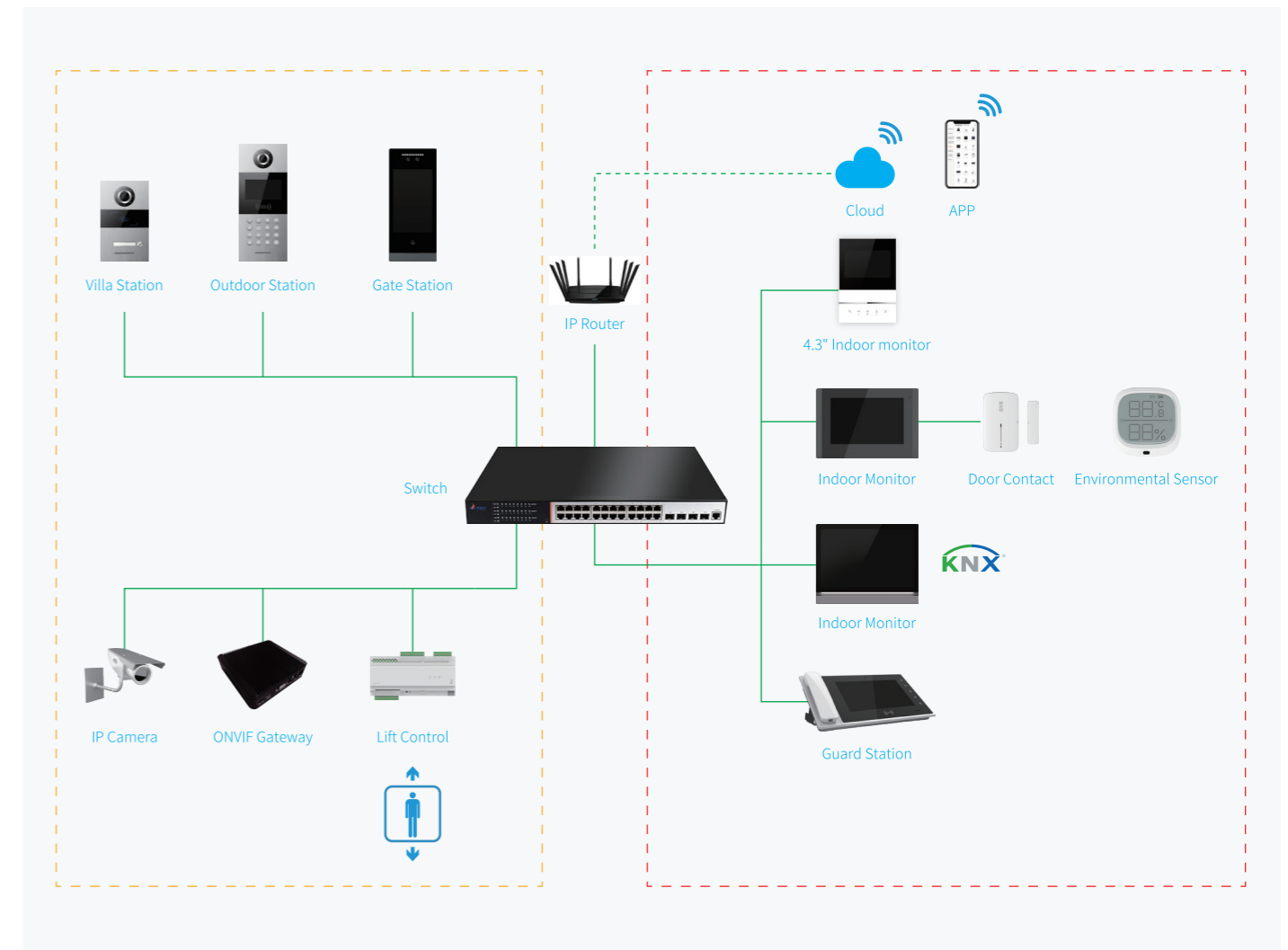

NEW!

8" Binocular Face Recognition Outdoor Station

H-OS18

Function:

- 2 megapixel HD camera
- Visual angle 123°
- Aesthetic design with aluminum faceplate
- 8" HD Display with sensitive touch panel
- Display resolution with 800*1280
- High precision algorithm for face recognition
- with approximate detection
- Door status detection
- Multiple call methods
- Slim device with 0.5cm thickness

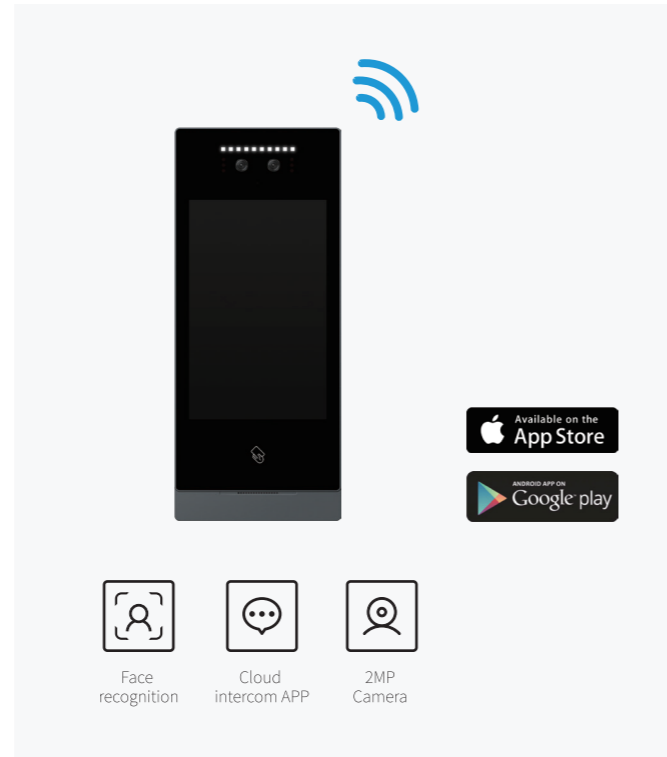

Mini Outdoor Station (Surface mounted)

H-VS07

Function:

- 2 megapixel HD camera
- Aesthetic design with aluminum alloy panel
- Support proximity card unlock
- Easy call to resident and security station
- Equipped with white supplement LED
- Door status detection
- IK07
- IP44

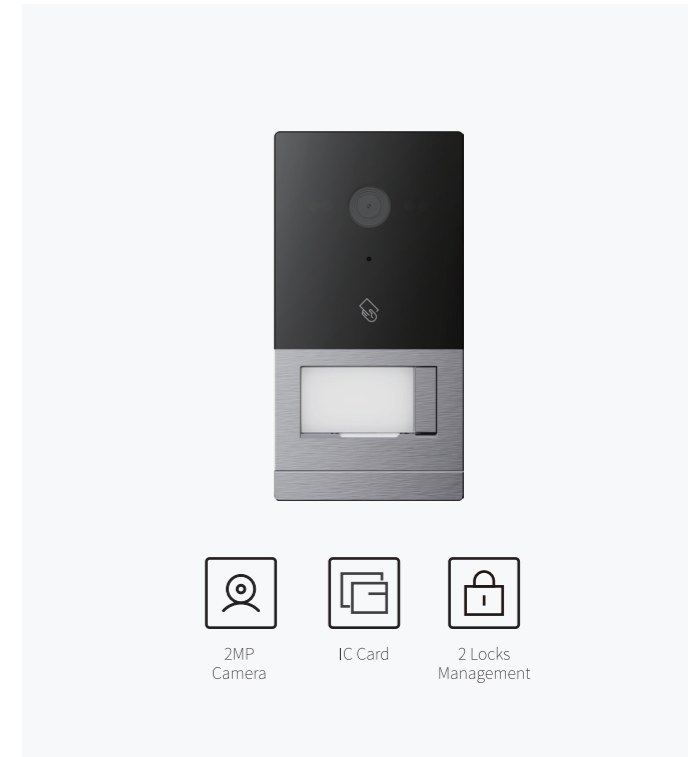

NEW!

4.3" IP Outdoor Station

H-OS09

Function:

- 2 megapixel HD camera
- Aesthetic design with aluminum faceplate
- Face recognition with approximate detection
- 4.3" LCD Display with sensitive touch panel
- View angle 123°
- Door status detection
- Fill-in light with high luminance LED
- Support IC Card
- Support normal-close /normal-open
- Support standard 48V POE
- Random password unlock and QR code unlock

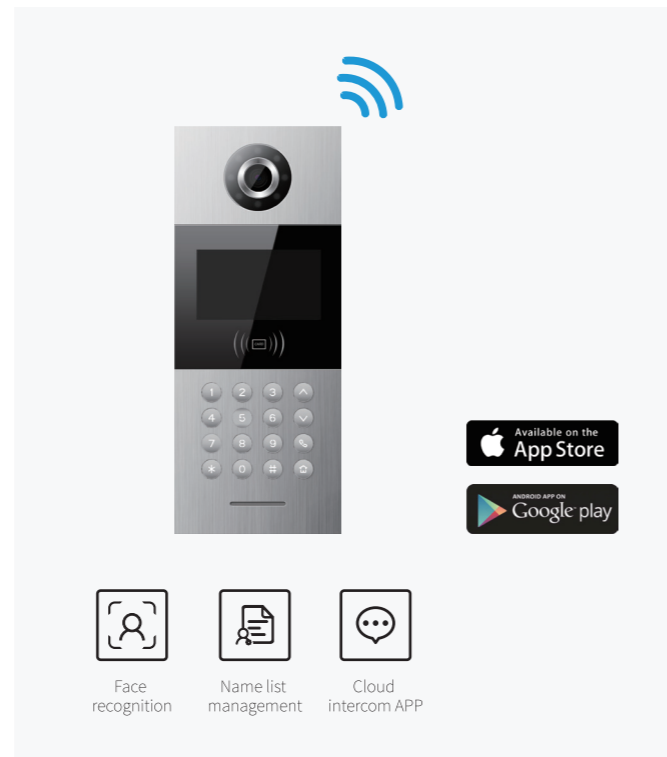

Mini Outdoor Station (Flush Mounted)

H-VS02

Function:

- Aluminum panel
- Working voltage: DC 24V (support POE)
- Support IC card
- Support intercom function
- Support tamper alarm
- IP44 Waterproof

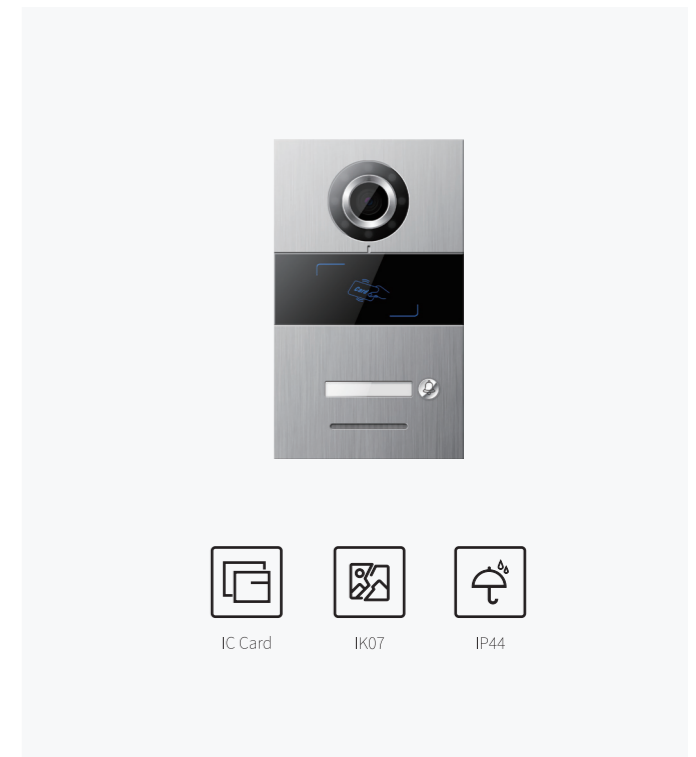

TCP/IP Video Intercom



H-IS19/H-IS33

10.1 " Indoor Monitor

- 10.1" glass capacitive touch screen
- Powered by 48V PoE & DC24V optional
- HD display with clear video performance
- Automatic photo capture
- Support intercom function
- Support call diverting
- Easy GUI customization
- Home automation & Elevator Linkage

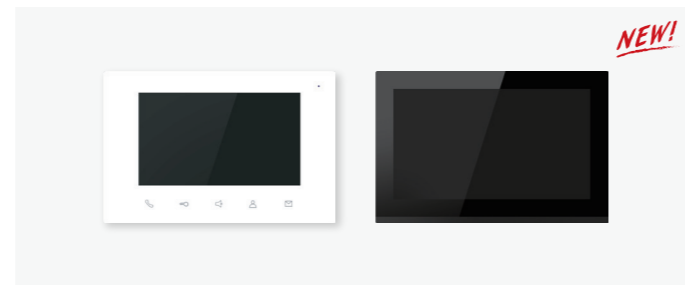

H-IS07/H-IS34

7 " Indoor Monitor

- Powered by PoE switch and DC24V optional
- 7" capacitive touch with advanced GUI
- Automatic photo capture
- Support intercom function
- Alarm settings with 8 defense zones
- Save up to 6 CCTV cameras in one monitor
- Home automation connection & Elevator linkage



H-IS02

4.3 " Indoor Monitor

- Working voltage: DC 24V (support 24V POE)
- Protocol: Standard TCP/IP
- 4.3" TFT with advanced display effect
- Automatic photo capture
- Support intercom function
- Sensitive touch key, cost-effective version



H-IS14

Audio Phone

- SOS Alarm
- Support multiple telephone
- Intercom between apartment & Guard Unit
- Ringtone/talking volume adjustable



H-CG01

IP Camera Gateway

- Support ONVIF IP camera
- Support up to 255 CCTV cameras
- Support 5 users' surveillance at the same time



H-LC02

Lift Control Module

- Working Voltage: DC 24V (support POE)
- RS485 protocol output



H-LC03

Lift Control Module (Dry Contact)

- Powered by DC 24V & 48V PoE
- Support TCP/IP LAN port in PoE
- Relay Interface with 16 fold relays max
- Transmitting Distance: 100M(Max)



H-CR02

Access Control Card Reader

- Max 10000 resident IC/ID card
- Powered by 24V PoE switch and DC24V optional
- Adjustable unlock duration
- Door status detection

android Android-based Devices

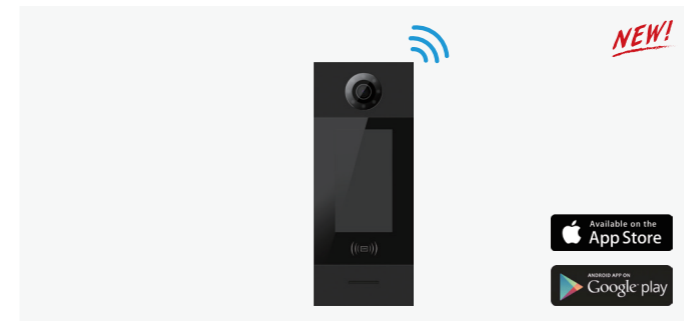

H-OS06

7" IP Outdoor Station

- 2 megapixel HD camera
- Aesthetic design with aluminum faceplate
- Face recognition with approximate detection
- 7" LCD Display with sensitive touch panel
- View angle 123°
- Door status detection
- Fill-in light with high luminance LED
- Support IC Card
- Support normal-close /normal-open
- Support standard 48V POE
- Random password unlock and QR code unlock *
- Cloud intercom APP is required

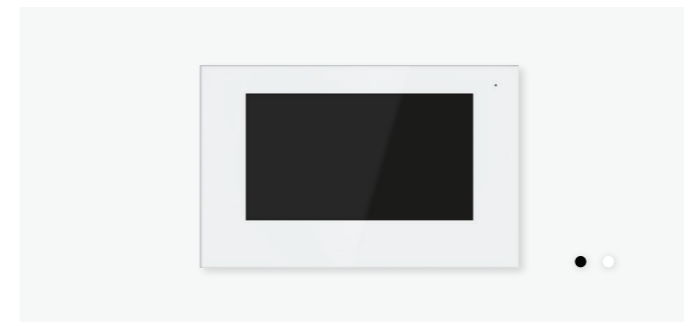

H-IS16

7" Indoor Monitor

- Working voltage: optional 24V/48V POE
- 7" capacitive touch with advanced GUI
- Automatic photo capture
- Support intercom function
- Alarm settings with 8 defense zones
- Save up to 6 CCTV cameras in one monitor
- Support KNX home automation connection

TCP/IP Video Intercom



A-IS03

KNX Smart Touch Z10

- Smart touch panel for both KNX and video intercom
- Aesthetic design with aluminum faceplate
- 10.1 inch colored IPS touch screen, 1280x800 resolution
- Support both map-view and list-view of all KNX functions
- Support optional 48V POE power & auxiliary 24V power
- Automatic photo capture, easy GUI customization
- Support intercom function
- Support call diverting



H-GU02

10" Guard Unit

- Support max. 255 IP cameras
- Card management function
- Alarm and SOS alert
- Support ONE-KEY (all) door opening
- PC Management system included



2-Wire Video Intercom

GVS T Series 2-wire video intercom system is an analogue system that helps to create convenient video intercom system between visitors and residents. The 2-wire connection, as one of the easiest way for intercom system, allows the system to be installed in small to medium building of all types with a limit of 128 apartments in one system, new or old.

The system supports both the conventional video intercom and the cloud video intercom (certain models) by Tuya app.

System capability:

-  Up to 128 indoor monitors
-  Up to 9 outdoor stations
-  Up to 160 meters cable

2-Wire Video Intercom

Typical 2-wire Topology

In/Out Connection:

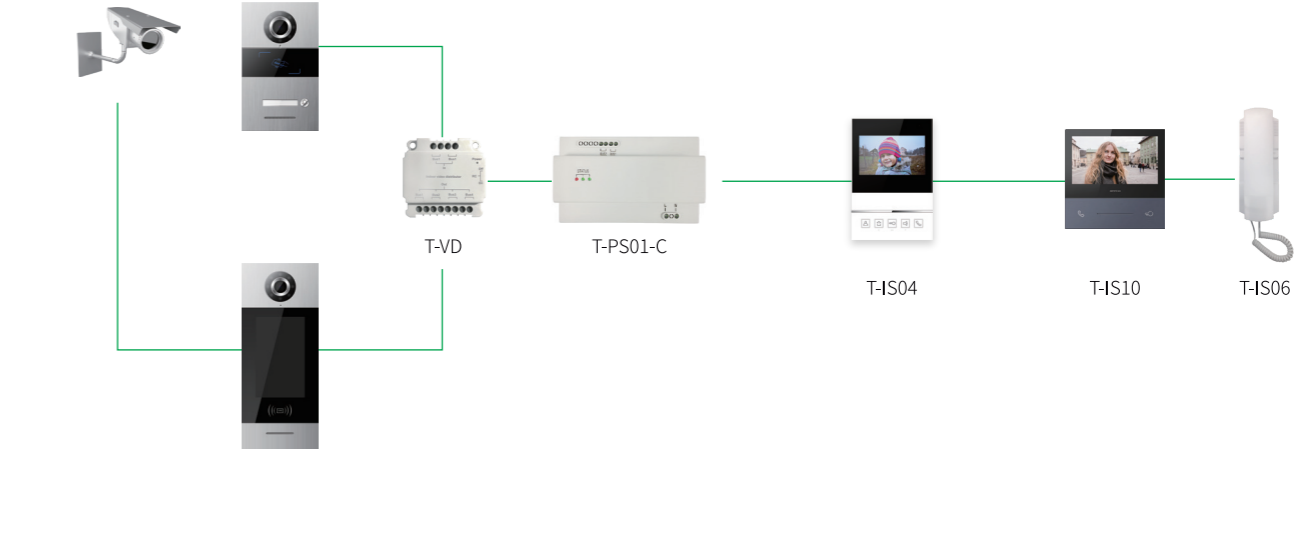

Star Connection:

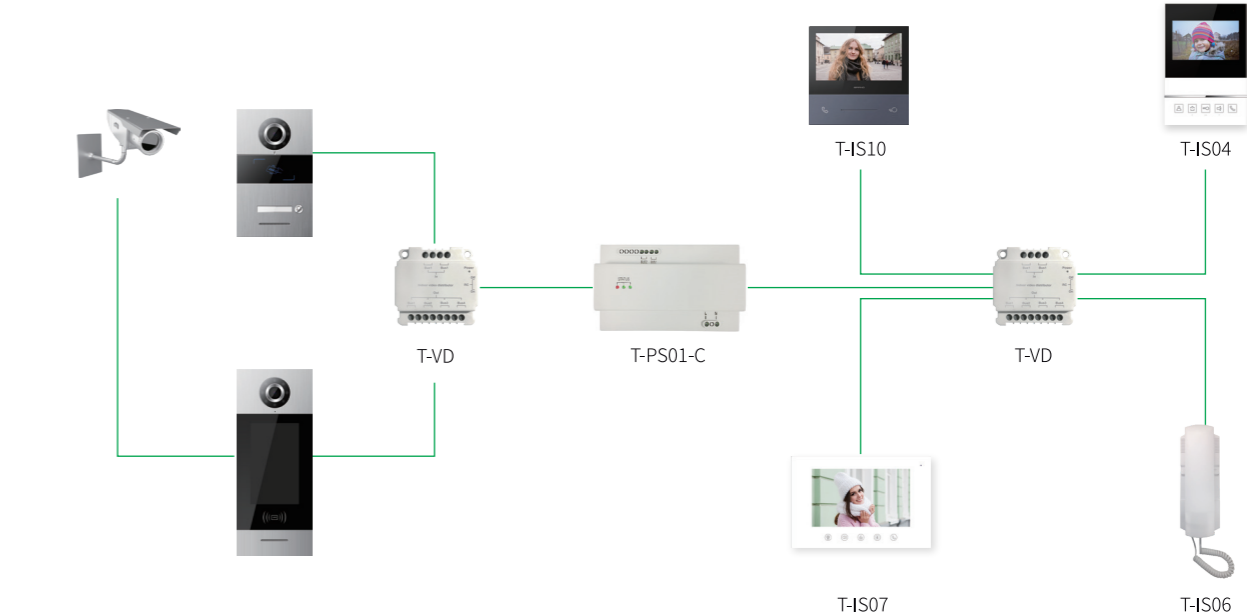

2-Wire Video Intercom

7" Touch Outdoor Station

T-OS02/T-OS14

Function:

- 7" capacitive touch screen design
- Aesthetic design with Aluminium panel
- Support analogue camera surveillance by built-in interface
- Support 2-wire centralized power supply
- Flexible GUI customization
- Name list program through 2-wire bus
- IC Card reader
- Main page can be configured as keypad or name list type



2.8" Keypad Outdoor Station

T-OS07

Function:

- Classic Aluminium panel
- Support analogue camera surveillance by built-in interface
- Support 2-wire centralized power supply
- Support Name list
- IC Card reader

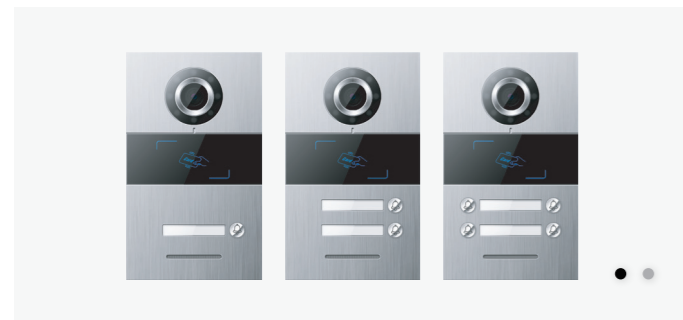

T-OS01/T-OS03/T-OS04

Mini Outdoor Station

- IC card reader
- Support unlock button interface
- Support white led light supplement
- IPX4 waterproof
- Flush mounted installation



T-OS16/T-OS17

Mini Outdoor Station

- IC card reader
- Name tag with LED backlight
- 2 locks management
- Adjustable call volume and unlock duration
- Surface mounted installation
- IP44 IK07

2-Wire Video Intercom



T-IS10

7" Indoor Monitor

NEW!



- 7" glass touch screen and nice touch keys
- Video intercom, monitoring and unlock
- Max.4 indoor monitors in one apartment
- Support TF card extension (2-32G)
- Support photo capture and video record
- Can be reused as guard unit when addressed as 200*
- Built-in multi-languages
- Cloud Intercom HD display with resolution 1024×600

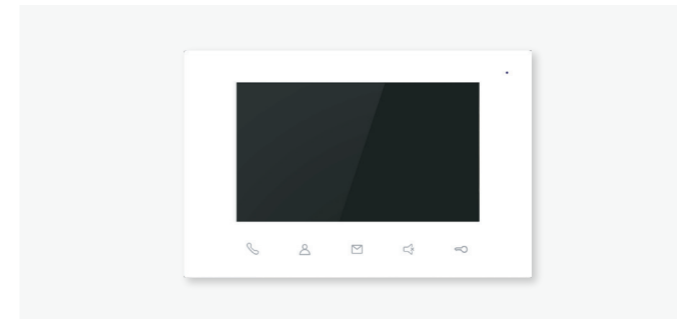

T-IS01

7" Indoor Monitor

- 7" glass touch screen and nice touch keys
- Video intercom, monitoring and unlock
- Max.4 indoor monitors in one apartment
- Support TF card extension (2-32G)
- Support photo capture and video record
- Can be reused as guard unit when addressed as 200*
- Built-in multi-languages
- Support intercom

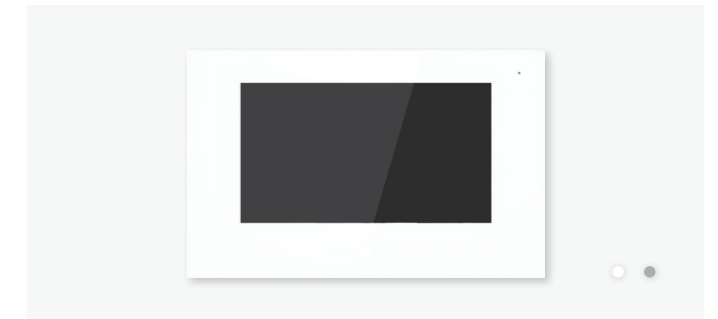

T-IS07

7" Indoor Monitor

- 7" glass touch screen
- Video intercom, monitoring and unlock
- Max.4 indoor monitors in one apartment
- Support TF card extension (2-32G)
- Support photo capture and video record
- Can be reused as guard unit when addressed as 200*
- Built-in multi-languages
- Support intercom

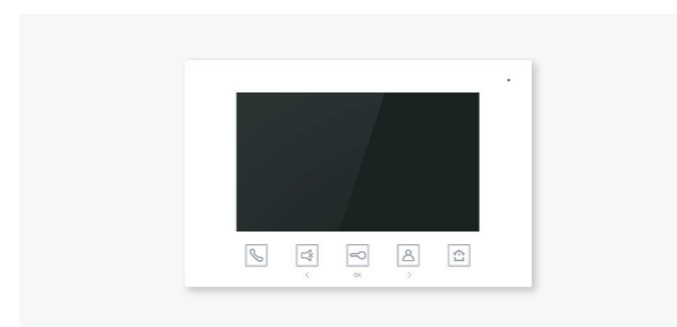

T-IS05

7" Indoor Monitor Lite

- 7" monitor with touch key with OSD
- Video intercom, monitoring and unlock
- Max.4 indoor monitors in one apartment
- Support intercom
- Can be reused as guard unit when addressed as 200*

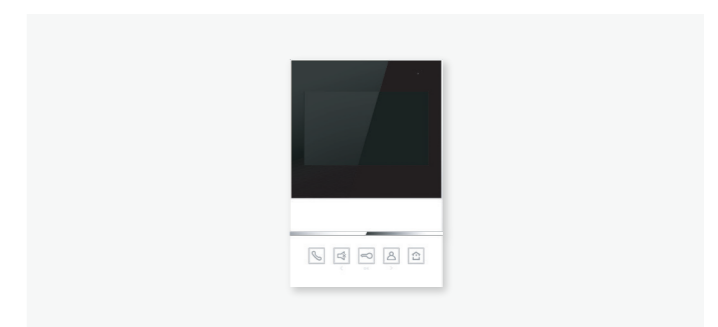

T-IS04

4.3" Indoor Monitor Lite

- 4.3" monitor with touch key design
- Video intercom, monitoring and unlock
- Max.4 indoor monitors in one apartment
- Can be reused as guard unit when addressed as 200*
- Support intercom

2-Wire Video Intercom



T-VD



T-OD



T-RA



T-CI

Monitor Distributor

- Connects up to 4 indoor monitors
- Necessary in a star connection topology to separate 4 monitors in one apartment (details please refer to topology diagram)

Door Station Distributor

- Connects up to 3 outdoor stations
- Necessary when there are more than 2 door stations in one system(details please refer to topology diagram)

Relay Control Module

- Relay for a second door lock
- Alternative for LED light controlling

Analogue Camera Interface

- For adding extra analogue cameras
- 3 channels available



T-Adaptor



T-PS01-C



T-PS02



T-GW01

Name List Tool

- For configuration of the name list in 7" Touch Outdoor Station

Power Supply

- Working voltage : AC100V~240V
- Output voltage : DC30V
- Support system power management
- Single power supply powers
- 32 indoor monitors maximum

Extended Power Supply

- Working voltage : AC100V~240V
- Output voltage : DC30V
- Supports max 16 indoor monitors for signal amplification

Analog Signal Converter

- Converting the analog signal into IP signal, for the 2 wire analog & Digital IP hybrid system projects



Plug & Play



Gift Package



Security Assured



Pro & Lite Version



WiFi

NEW!

Tuya Video Kit

2-wire intercom kit

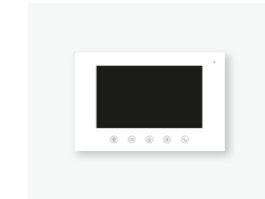

7" Indoor Monitor

- 7" colored TFT display
- Touch Panel & Touch buttons
- Elegant design

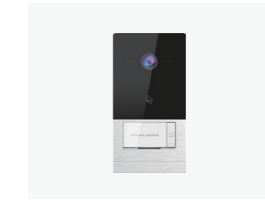

Outdoor Station

- IP44 · IK07
- Max. 2 apartments supported
- Easy and secured surface-mounting

NEW!

Way-2-Easy Kit Pro

2-wire intercom kit

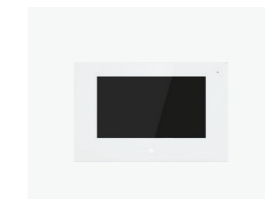

7" Indoor Monitor

- 7" color TFT display
- Sensitive touch panel
- Photo & Video recording

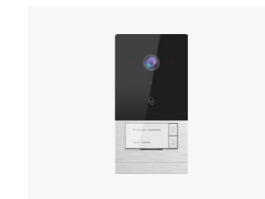

Outdoor Station

- CMOS camera 600TVL
- Aluminium alloy panel
- Proximity card reader
- 2 locks management
- IP44 IK07



Power supply

- Standar din-rail installation
- AC 100-240V, 50-60Hz, 600mA
- Support max 6 devices



Plug & Play



Gift Package



Security Assured



Pro & Lite Version

Monitor Selection Table

	H-IS14	H-IS02	H-IS07	H-IS11	H-IS16	H-IS33	H-IS19	T-IS06	T-IS04	T-IS05	T-IS01	T-IS07	T-IS10
Screen size	/	4.3"	7"	7"	7"	10.1"	10.1"	/	4.3"	7"	7"	7"	7"
Color	White	White/Black	White/Black	Silver/Black	White/Black	Black	Black	White	Black	White	White	White/Black	White/Grey
Power supply mode	24V PoE	24V PoE	24V/48V PoE	24V/48V PoE	48V POE	24V	48V POE	2 wire PS 3.0V	2 wire PS 3.0V	2 wire PS 3.0V	2 wire PS 3.0V	2 wire PS 3.0V	2 wire PS 3.0V
Touch screen	/	/	Yes	Yes	Yes	Yes	Yes	/	/	/	Yes	Yes	Yes
Picture memory	/	Yes	Yes	Yes	Yes	Yes	Yes	/	/	/	Yes	Yes	Yes
Button type	Mechanical button	Touch key	Touch panel	Touch panel	Touch panel	Touch panel	Touch panel	Mechanical button	Touch key	Touch key	Touch panel	Touch panel	Touch panel
Dimension WxHxD(mm)	209.9x79.9x52.8	180x123x20.5	220x140x17.5	200x130x14.9	220x140x17.5	247.5x165x17.4	305x206x28	209.9x79.9x52.8	180x120x19.5	220x140x24	220x140x24	220x140x24	179.6x179.6x25
Technology	Non-polarised Two-wire												
Number of wires	2												
Max. distance(meters)	160												
Guard unit	Yes												
Max. number of apartments	128												
Extension per apartment	4												

Featured Project

Classic GVS project worldwide
P. 029 - P. 033

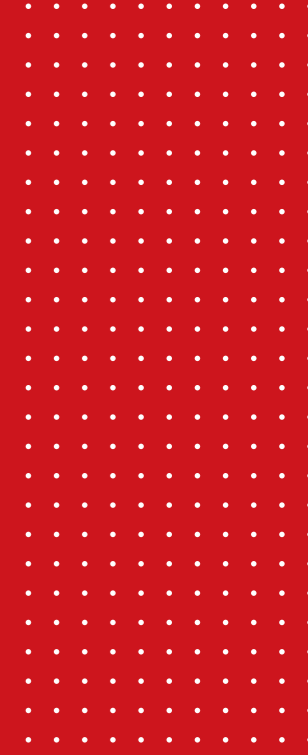

Featured Project



Daxing International Airport

- Location : Beijing, China
- Project Type : Airport
- Size : Departure Lounge & Landing Field

Beijing Daxing International Airport, as one of the TOP 3 airports globally, has finished its last phase of installation in mid 2019. The airport is famous for its unique and elegant design as well as its huge capacity for passengers, it's praised as one of "The New Seven Wonders Worldwide" by British Guardian. GVS, as the leader of the smart building in China, has participated in the airport automation in its decoration phase and successfully installed thousands of KNX components in the brand new airport to enable smart lighting control, HVAC control etc. Till today, Daxing International Airport has become the biggest and most successful KNX airport project.

Guangzhou Metro System

- Location : Guangzhou, China
- Project Type : Metro Station
- Size : 42 stations lighting control

GVS has won the KNX automation part in the latest THREE Guangzhou new lines: line #13, #14, #21 with 42 stations. The whole project has successfully been installed in 2018 and handedover to the civic operation office. With a huge number and extreme length, the Guangzhou Metro system now becomes the largest KNX automation system in the category of metro system worldwide. Besides, GVS is also working closely with metro/train station systems in other major cities like Shenzhen, Ji'nan, Zhangjiajie, Foshan etc.



Hangzhou International Airport
Hangzhou, China

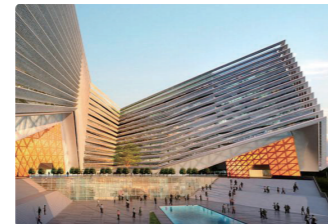

Alibaba Headquarter,
Hangzhou, China



Guangzhou Metro,
Guangzhou, China

Featured Project

Wuxi Spring Garden Wuxi, China



Qianjing Garden Shanghai, China



Haoyuan Apartment Xinjiang, China



Haoyuan Community Jinan, China



Scandinavia Luxury Apartment

- Location: Jakarta, Indonesia
- Project Type: Commercial-Residential Complex
- Size: 1000+ apartments

With the help of GVS smart community technology, Scandinavia Apartment becomes one of the most significant building in Jakarta city. The Commercial-Residential complex solves the living problem, while GVS smart community solution improves the living quality. Over 2,000 GVS video intercom & KNX smart home devices contributed a lot in the automation & security of the building in 2018.

Smart Istanbul Residential Community

- Location: Istanbul, Turkey
- Project Type: Residential
- Size: 3000 Residence

As the biggest residential community in the capital city, the best smart community solution is required for a better living and management. By using GVS IP video intercom system, it offers a stable & reliable solution for the video intercom among visitors, residence and security guard. What's more, it also makes this huge community closely connected & smarter with features of alarm, surveillance, face recognition, remote APPs, lift control, QR code unlock etc.



Featured Project

Résidence Marcel Marlier
Tournai, Belgium



Yun Shan Shi Yi Community
Guangzhou, China



Seri Pilmoor 110 Villas
Kuala Lumpur, Malaysia



HuaYuan · Dayi Resort
Guangzhou, China



JIN MAO Palace Condominium

- Location: Guangzhou, China
- Project Type: high-end condominium
- Size: 2400+ condo apartments

CHINA JIN MAO GROUP, as a Fortune 500 Company, is one of the biggest real estate and hotel investment group company in China. As s strategic partner of JIN MAO group, GVS has successfully helped the real estate giant in its condominium projects in Shenzhen, Guangzhou, Fuzhou, Xianmen and other big cities in China. With a combination of GVS tailored switches and solutions based on KNX home and building automation system, the high-end condos nowadays produced by JIN MAO are leading the real estate industry with smart home conception.

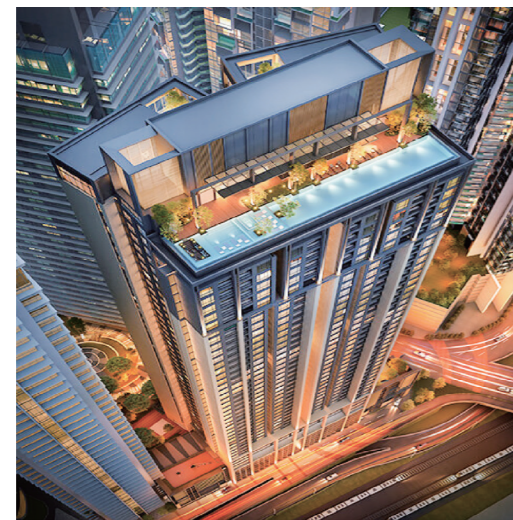

KL Eco City

- Location: Kuala Lumpur, Malaysia
- Project Type: Commercial-Residential Complex
- Size: 500+ apartments

As special commercial & residential complex, the KL Eco City in Malaysia has planned quite environmentally friendly systems, among which KNX is one of the most important system. Over a thousand and half pcs of KNX devices from GVS have contributed to the automation of the building, helping the project win the first GBI Gold Medal in Malaysia.

Featured Project



Grand Hyatt Athens

- Location: Athens, Greece
- Project Type: 5-Star Hotel
- Size: 300 guest rooms

Grand Hyatt Greece, as a 5-star luxurious hotel under Hyatt Hotel Group, reopened in 2018 after a systematic renovation with GVS KNX hotel system. The hotel, as a landmark of Athens, started to accept its customers since 1983 and stopped in 2010 because of the crisis. Based on the latest KNX technology, GVS helped the hotel in its automation part and finally turned the hotel to smarter and more comfortable one with its advanced KNX technology.

Fairmont Marina Residences

- Location: Abu Dhabi, UAE
- Project Type: hotel residences
- Size: 249 serviced apartments

Fairmont Marina Residences, a 39-storey Arabian themed skyscraper which resembles the hotel located at the top of Dubai's Palm Jumeirah, is the first Fairmont-branded hotel residences in the UAE, it's part of the 563-room Fairmont Marina Resort in Abu Dhabi.

GVS, by actively participating in the hotel decoration process of the project, has worked with a few other KNX brands and successfully equipped the hotel residences with the latest smart hotel technology.



InterContinental Hotel
Wuxi, China



Falkensteiner Schlosshotel
Austria



Herbarium Hotel & SpA
Gmina Gąsawa, Poland



W Hotel
Guangzhou, China

**Beijing No. 1 Social
Warefare Home**
Beijing, China



**Evergrande Group
Healthyland**
Sanya, China



**The General Hospital of the
People's Liberation Army**
Beijing, China



**Vanke Tianjin Yiyuan
Elderly Care Center**
Tianjin, China



Ji'nan Maternal and Child Healthcare Hospital

- 📍 Location : Ji'nan, China
- 🏢 Project Type : Smart Hospital
- 📏 Size : 50+ pediatrics patient rooms

Ji'nan Maternal and Child Healthcare Hospital is a famous First-class Hospital at Grade Three for women and children, the hospital is an integration for healthcare, scientific research and medical teaching, with its inpatient and out patient amount ranking first in Shandong Province. In October 2018, it became the 1st smart hospital under help of GVS team by installing the very first Smart Pediatrics Ward in Shandong Province with a total number of 50+ patient rooms. The smart ward has a variety of new functions such as visitor management system, smart information display, smart clinical date collection system, and all functions are transmitted by different protocols like LoRa, BLE, RFID, WiFi and KNX. As an excellent IoT service provider, GVS successfully integrated all protocols and made the hospital a smart and modern one.

How it works for a smart hospital?

